







Replacement of consumables

- Be sure to observe the following items for replacement of consumables.

 DANGER	
 <p>PERSON WHO FULLY UNDERSTANDING THIS MANUAL MAY PERFORM REPLACEMENT OF CONSUMABLES. ※ Otherwise, electric shock, injury, trouble, or damage may occur.</p>	
 <p>DO NOT MODIFY THE AS-100. ※ Otherwise, electric shock, injury, trouble, or damage may occur.</p>	 <p>BE SURE TO TURN OFF THE POWER, STOP SUPPLY OF COMPRESSED AIR, AND RELEASE THE RESIDUAL PRESSURE BEFORE REPLACEMENT OF CONSUMABLES. ※ Otherwise, electric shock or injury may occur.</p>

 WARNING	
 <p>INSTALL THE REMOVED COVERS AGAIN AS THEY WERE. ※ Otherwise, electric shock or injury may occur.</p>	 <p>WHEN MORE THAN ONE PERSON WORKS, CALL TO EACH OTHER. ※ Otherwise, electric shock or injury may occur.</p>

 CAUTION	
 <p>DO NOT MAKE IMPACT ON THE SH-100. ※ Otherwise, trouble or damage may occur.</p>	

1 Hexagonal belt

● Take the following steps..

- 1 Turn off the power to equal distribution motor and winnowing motor.
- 2 Loosens a tension bolt and replace the hexagonal belt.
- 3 Put the belt cover back in place.

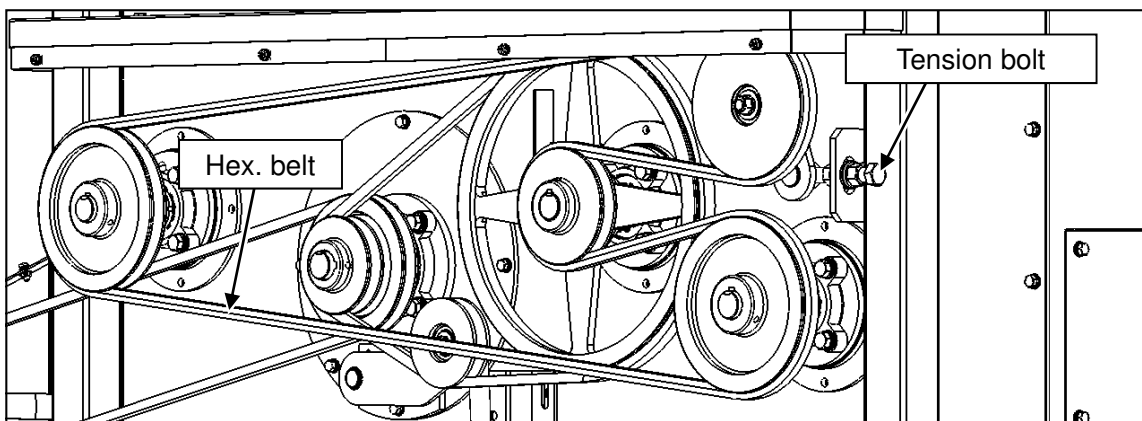

2 Screw V belt

● Take the following steps..

- 1 Turn off the power to equal distribution motor and winnowing motor.
- 2 Remove the hexagonal belt as described in "9.1.1 Hexagonal belt".
- 3 Remove the idler pulley and replace the screw V belt.
- 4 Put the hexagonal belt and belt cover in place.

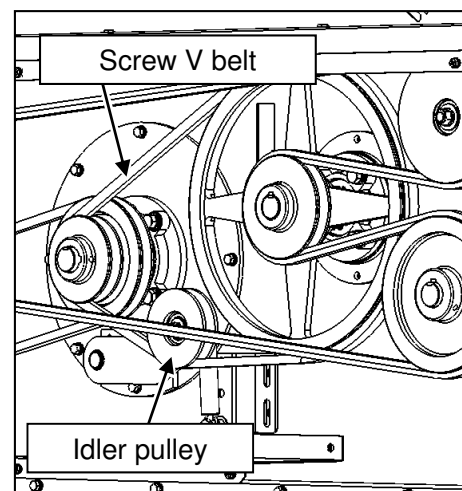

3 Fan V belt

● Take the following steps.

1 Turn off the power to the equal distribution motor and winnowing motor.

2 Remove the hexagonal belt as described in “1 Hexagonal belt”.

3 Remove the screw V belt as described in “2 Screw V belt”.

4 Loosen four motor mounting nuts and two belt tension bolts, and then remove the fan V belt.

5 Hook the fan V belt to motor pulley, and tension with V belt tension bolt. Tension the belt so as not tilt the motor, and fix it with nuts.

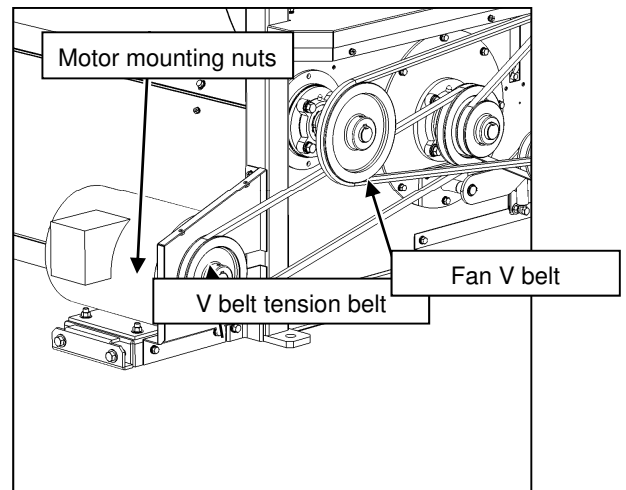

6 Loosen the motor mounting nuts and fix the winnowing motor.

7 Put screw V belt, hexagonal belt, motor belt cover, and belt cover in place.

4 Equal divide screw vane

● Take the following steps..

1 Turn off the power to equal distribution motor and winnowing motor.

x

2 Loosen M12 nuts and remove equally distributing screw vanes.

For installation, fix the screw vanes in contact with equally distributing screw shaft as shown in the figure on the right.

As shown in the figure below, install the screw vanes symmetrically with care for direction.

There are 12 equally distributing screw vane.

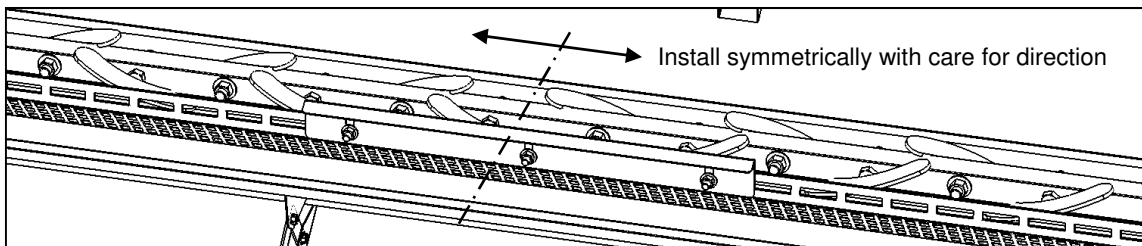
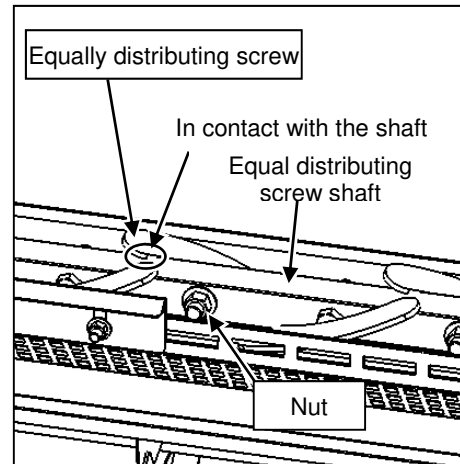

3 Close the Equal division window .

5 Emission screw

● Take the following steps.

1 Turn off the power to equal distribution motor and winnowing motor.

2 Remove the hexagonal belt as described in "1 Hexagonal belt".
When replacing the emission screw of port 2, removes the screw V belt, too, according to the steps of "2 Screw V belt".

3 Remove the emission screw bearing on the front side. Remove the bearing cover, and loosen the bearing nut to come off from the emission screw.
Loosen M12 bolts, and remove the emission screw bearing.

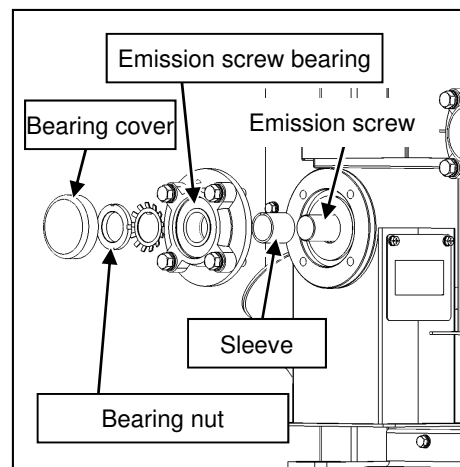

4 Remove the pulley. Each pulley is fixed with M8 fixing screws.

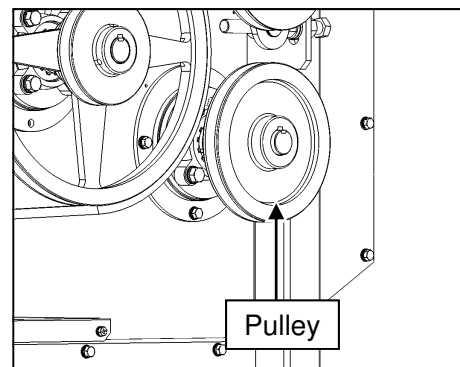

5 Remove the emission screw bearing assembly on the rear side.
Loosen the bearing nut and loosen M8 bolts, and remove the emission screw bearing assembly.

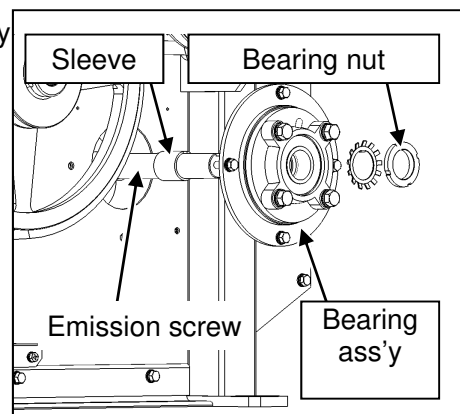

6

Replace the emission screw.

NOTE

- Emission screw for port 1 and 3 and that for port 2 have different screwing directions. Be careful.

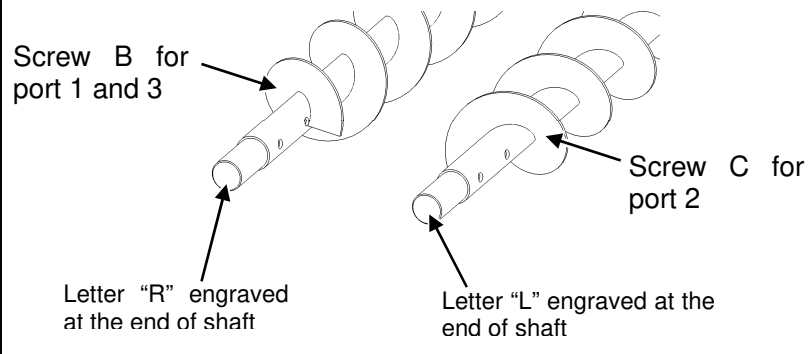
**7**

Put the removed parts back in place.

The position of emission screw is as the size shown in the figure on the right.

Attach the internal surface of the bearing to tapered surface of the sleeve closely and tighten up the bearing nut.

The tightening torque is 39 N·m.

Adjust the position of each of pulley and install them so that the screw V belt and the hexagonal belt become straight.

