

## 5.4 Replacing consumable

### 5.4.1 Replacing the Screen

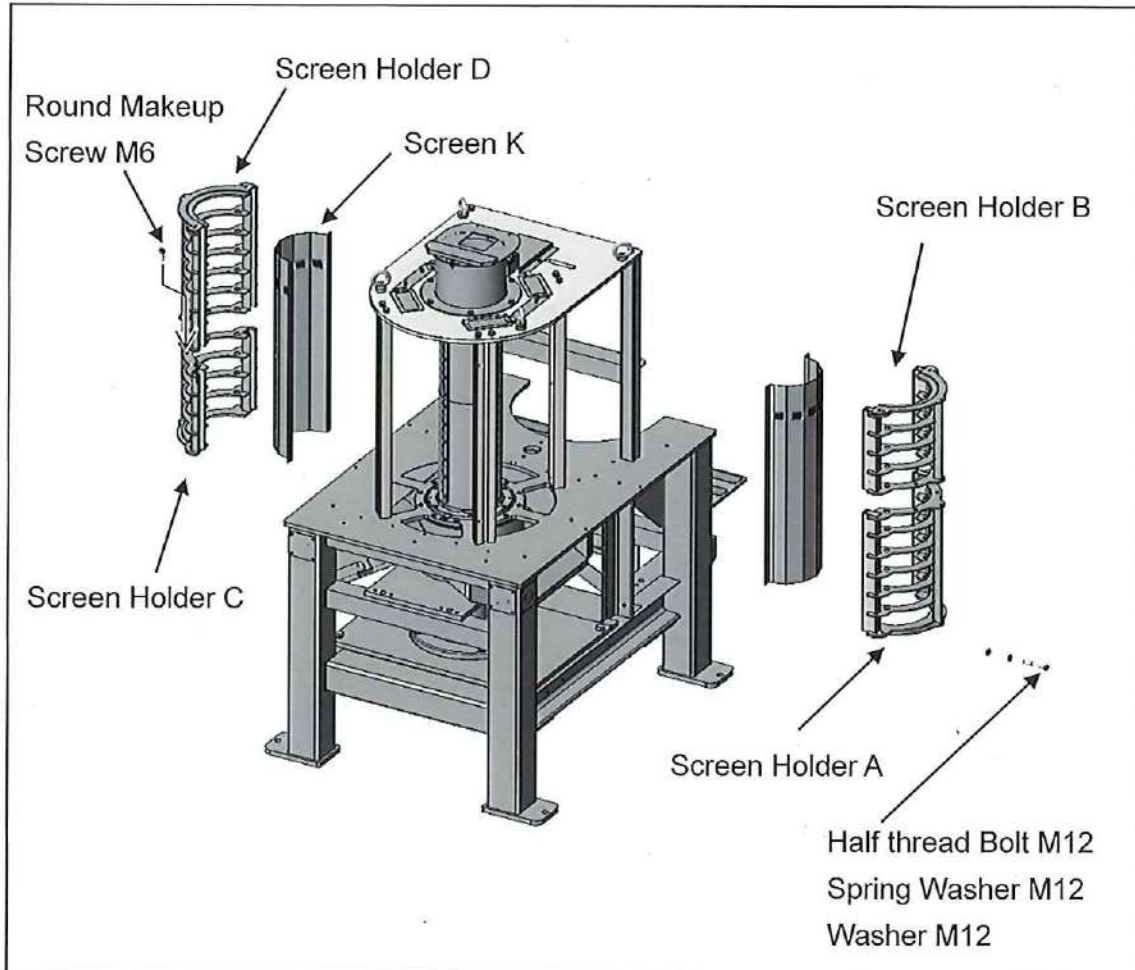

- ① Remove Bran Case C and D (Refer to P.51).
- ② Remove Bolt M12 (12 pcs), Round Makeup Screw (1 pc) and take out the Screen Holders and Screens.
- ③ Clean the bran from the Screen Holders, Screens and places where parts attach, and then install the new Screens.

#### NOTE

- If bran, etc. is not removed, the screen may not set correctly and could become damaged by vibration.

## 5.4.2 Replacing the Screw

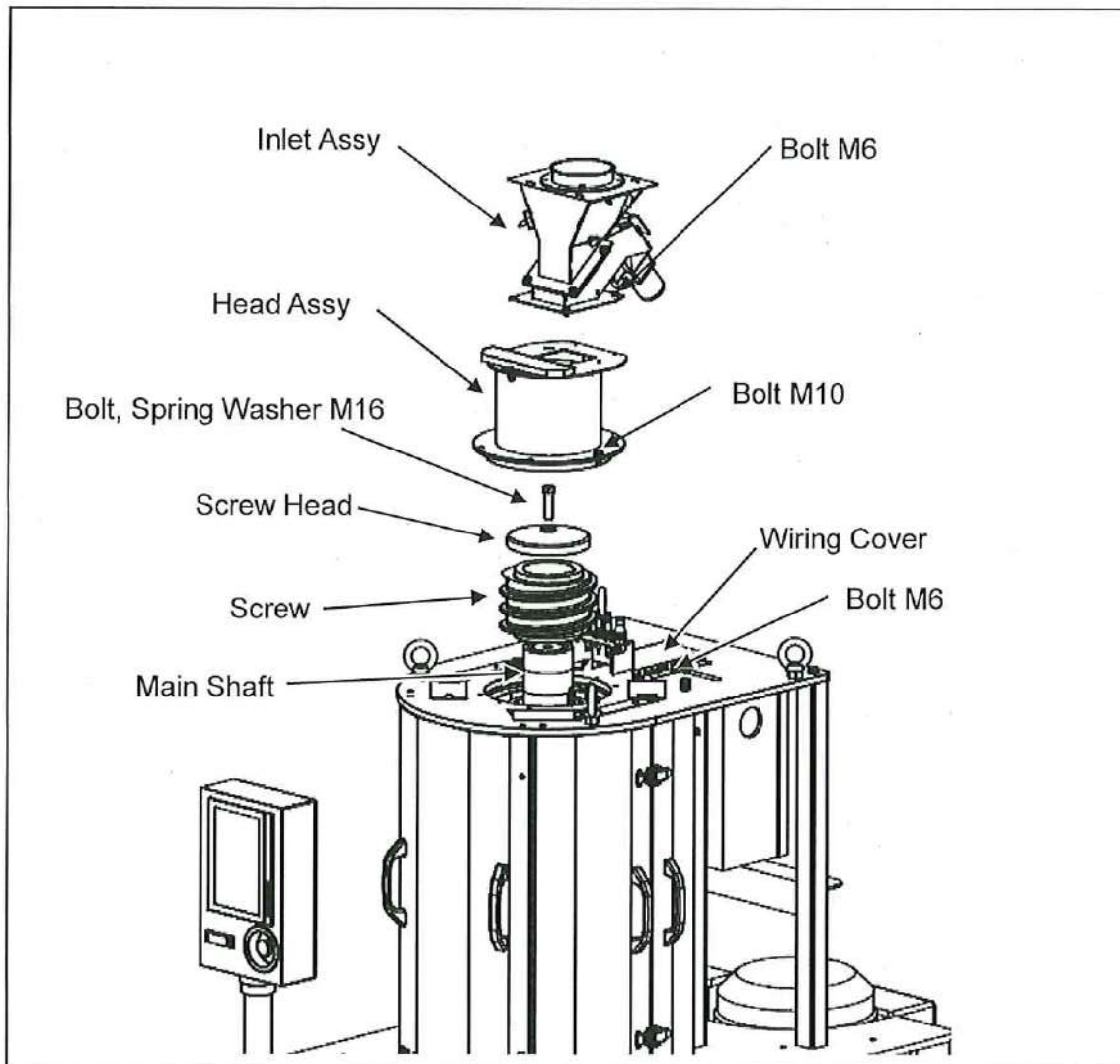

- ① Remove the Bolt M6 (4 pcs) of Inlet Assy and take out the Inlet Assy.
- ② Remove the Bolt M10 (6 pcs) of Head Assy and take out the Head Assy.
- ③ Remove the Bolt M6 (2 pcs) of Wiring Cover and take out the Wiring Cover.
- ④ Remove the Bolt M16 and take out the Screw Head, Screw.
- ⑤ Insert a new screw into the main shaft and assemble in the reverse order.

### 5.4.3 Replacing the Polishing Roll

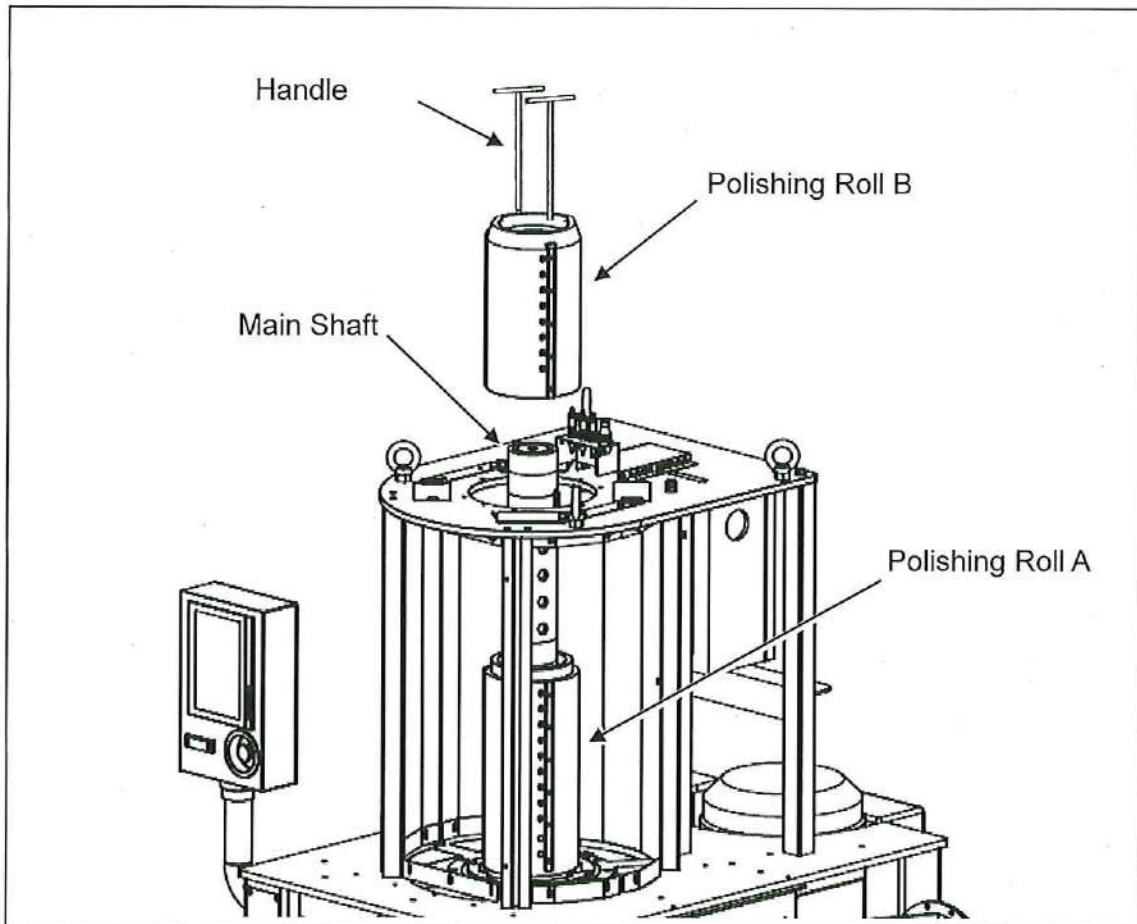

- ① Insert the handles (accessory) into the two locations on the upper surface of Polishing Roll B and screw them.
- ② Pull the two Handles straight up so that Polishing Roll does not tilt.
- ③ Pull the Polishing Roll A in the same way.
- ④ Replace with a new Polishing Roll and assemble in the reverse order.

#### 5.4.4 Replacing the Polishing Roll Rib

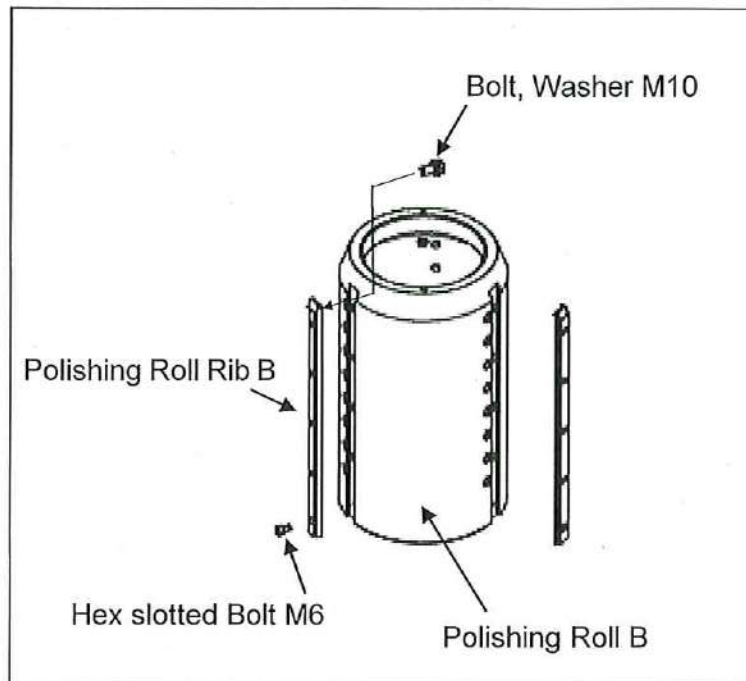

- ① Remove recessed Bolt M10 (12 pcs) from inside Polishing Roll B, hex slotted Bolt (3 pcs) from outside, then take out the Polishing Roll Rib (3 pcs).
- ② Replace with new Polishing Roll Rib and assemble in the reverse order.
  - Do for Polishing Roll A on the same way.