











Replacing consumables

- The following precautions apply to replacing consumables.

 Danger	
 <p>Maintenance and inspection of the rice milling machine must be performed by a person who fully understands this instruction manual.</p> <p>* There is a risk of electric shock, injury, failure, or damage when operated by a person who does not understand it.</p>	 <p>Always turn the power off when performing maintenance and inspection of the rice milling machine.</p> <p>* Otherwise, electric shock or injury may occur.</p>

 Warning	
 <p>Whenever a cover is removed, return it to its original position.</p> <p>* Otherwise, electric shock or injury may occur.</p>	 <p>When multiple people are working together, make sure they communicate with each other.</p> <p>* Otherwise, electric shock or injury may occur.</p>

 Caution	
 <p>Do not climb on the covers of the rice mill.</p> <p>* They may become damaged or unable to be attached.</p>	 <p>Do not subject the rice mill to severe impacts.</p> <p>* It may result in failure or damage.</p>
 <p>Do not modify the rice mill.</p> <p>* It may result in injury, failure, or damage.</p>	

1 Replacing consumables in the Friction section

1.1 Replacing the Screen

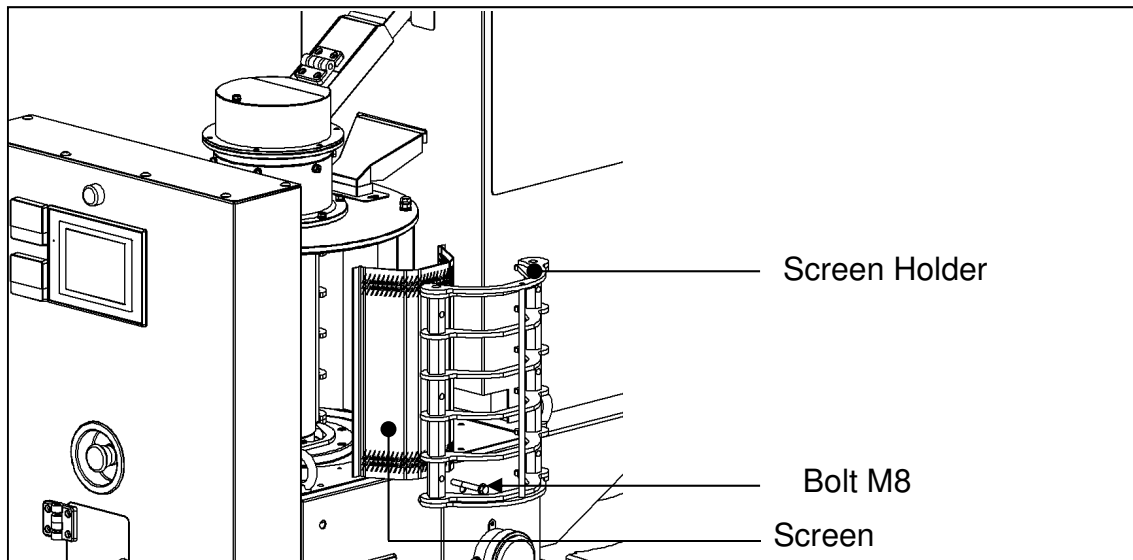

1 Remove the Bran Case G.

2 Remove Bolts M8 (6 pieces) and take out the Screen Holder and Screen.

3 Clean the bran from the Screen Holder, the Screen and place where parts attach, and then install new Screens.

Note

- If bran, etc. is not removed, the screen may not set correctly and could become damaged by vibration.

1.2 Replacing the Screw

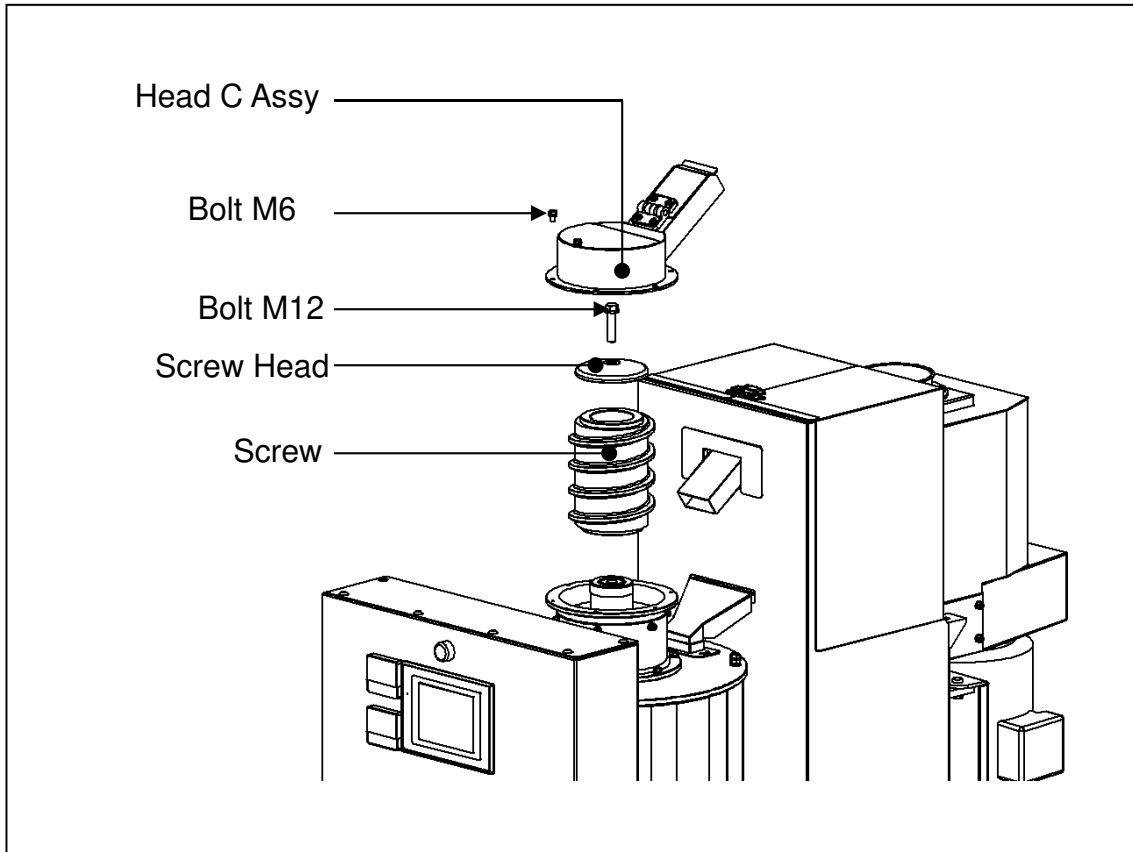

- 1** Remove Bolt M6 (6 pieces) from the Head C assembly and remove the Head C assembly.
- 2** Remove Bolt M12, then remove the Screw Head and the Screw.
- 3** Clean the bran where parts contact fully and insert a new Screw into the Main Shaft and assemble in the reverse order.

13 Replacing the Friction Roll

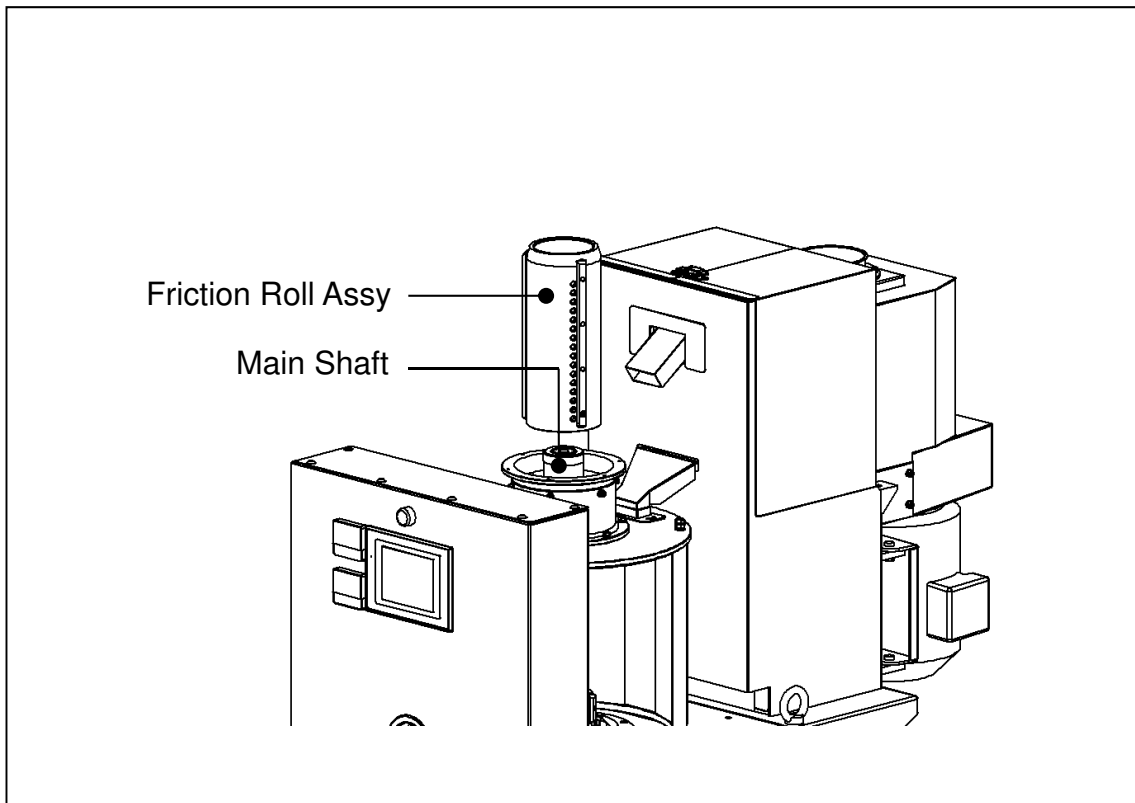

- 1** Hit the Friction Roll assembly with plastic hammer etc. lightly.
- 2** Set the crow to the lower part of Friction Roll and lift it, then pull the Friction Roll assembly from Main Shaft.
- 3** Replace with a new Friction Roll and assemble in the reverse order.

1.4 Replacing the Inner Ring

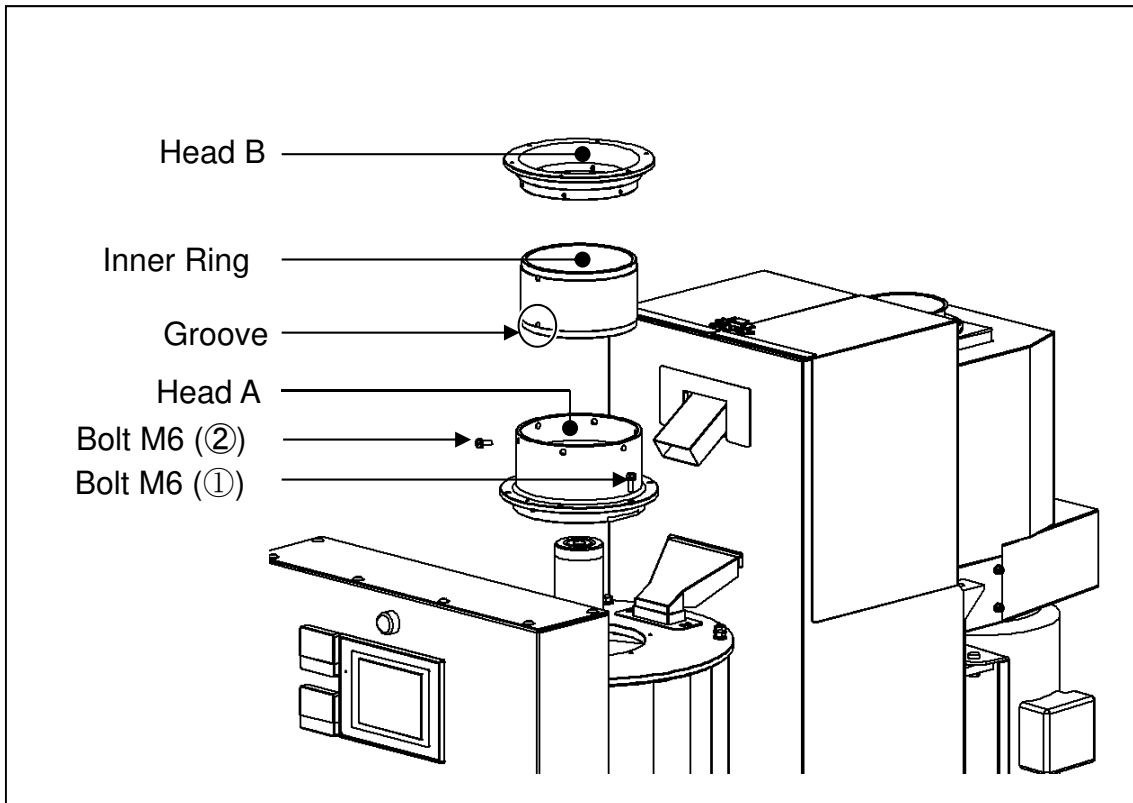

- 1** Remove the 6 pieces of Bolt M6 (①) and remove the Head A, Inner Ring and Head B as one assembly.
- 2** Remove the 6 pieces of Bolt M6 (②) and take out the Head B and remove the Inner Ring.
- 3** When attaching the Inner Ring, incorporate it into Head A so that the groove aligns with the convex portion of Head A.

1.5 Replacing the Friction Roll Ribs

1 Remove the recessed Hex Bolt M5 and Bolt M8 (3 pieces) on the inside of the Friction Roll and remove the Friction Roll Ribs.

2 Replace with the new Friction Roll Rib, assemble in the reverse order.

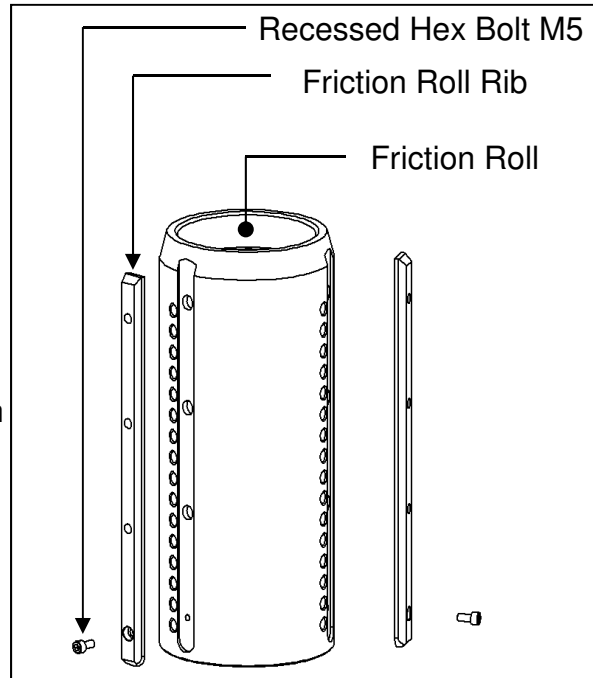

2 When replacing the Abrasive Roll (stone)

- It is necessary to dress the Abrasive Roll when replacing it with a new one.
- If the stone is not dressed while milling, bran will clog the surface of the Abrasive Roll and the abrasive effect will not be effective. Dressing is performed with milled rice.

Note

- Replacing the Abrasive Roll (stone) is required to conduct by qualified person.